

PS662

HM saw blades ZAG 1 -CHIPBOARD- series for plunge saws

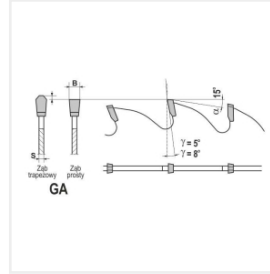
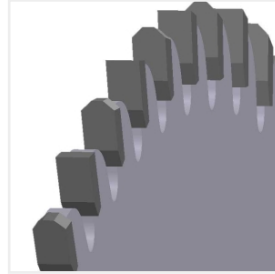

Features - benefits

- » SUPER HARD carbide tips (ULTRAFINE) with hardness of 2.100 HV ensures longer life time
- » due to high sintered carbide hardness its sharpening is performed on CNC sharpening machines with specially chosen grinding wheel and sharpening parameters
- » saw blades with teeth geometry GA (TR-F triple-chip + flat)
- » diameter range for most of the plunge saws available on the market
- » saw blade can be used also on table saw machines and power tools

Application

- » for precise cutting and scoring of wood-based materials eg. chipboard, laminates, mdf
- » used mostly for cutting of laminated furniture boards and floor boards, also for cutting out in worktops and for grooving
- » to choose the proper saw blade it is recommended to consider not only type of material but also its size: thickness, cross section or in case of profiles - wall thickness
- » maximal cutting height or depth depends on plunge saw type
- » in order to obtain the best possible surface finish and with a view to a safe cutting process, it is necessary to apply the correct clamping pressure - the workpiece/piece should be fixed in a clamping fixture, e.g. a clamping bench or workbench

Catalogue	Index	Ø D [mm] Outer diameter	Ø d [mm] Inner diameter	B [mm] Kerf	S [mm] Disc thickness	Z Teeth number	Teeth geometry	Rake angle °	U.m.
●	P5662-0160-0001	0160	20	2,2	1,6	56	GA	5	szt.
●	P5662-0160-0002	0160	20	2,2	1,6	48	GA	8	szt.
○	P5662-0160-0003	0160	30	2,2	1,6	60	GA	5	szt.
●	P5662-0165-0001	0165	20	1,8	1,4	48	GA	8	szt.
●	P5662-0210-0001	0210	30	2,2	1,6	52	GA	5	szt.

INFO:

Producers of plunge saws may modify their products within the validity of the offer for Globus tools. That is the reason why we request you to check the type of plunge saw (especially external and internal diameter -bore diameter) before purchase of particular saw blade.

Download

[TechInfo_PS_eng.pdf](#)

Related products

[HM saw blades ZAG 2 -WOOD- series for plunge saws](#)

[HM saw blades ZAG 3 -SPECIAL- series for plunge saws](#)

[HM saw blades ZAG 4 -STANDARD- series for plunge saws](#)

[GO Cleaner - cleaning fluid for tools and machines](#)

