

PS602

HM saw blades MITER 2 -WOOD- series for miter saws

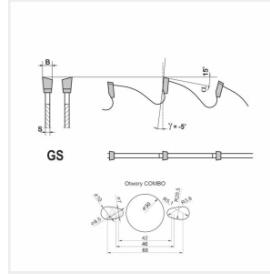
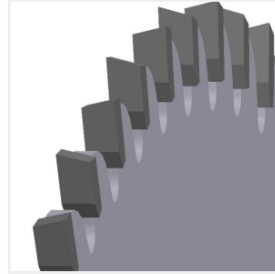

Features - benefits

- » HARD carbide tips (ULTRAFINE) with hardness of 1.950 HV ensure longer life time
- » thin kerf and disc give the feeling of easy saw blade operating while cutting
- » saw blades produced as industrial saw blades where the deviation from nominal size does not exceed hundredths of millimeter
- » use of high quality tool steel as well as specialized disc tensioning technology guarantees proper saw blade rigidity while operation
- » sharpening process performed on CNC sharpening machines with specially chosen grinding wheel and sharpening parameters
- » designed compensation slots increase warp resistance due to high temperature and load

Application

- » universal saw blade for soft and hard wood cutting
- » dedicated also to cutting of plywood and wood-based materials with natural veneer
- » precise cutting due to teeth geometry (alternate top bevel) with small teeth pitch (great number of teeth)
- » cutting of soft wood - boards, battens, counter battens etc., chipboard with natural veneer - door frames etc.
- » angled, mitre and straight cutting, grooving
- » used in mitre, radial arm and table saws
- » in order to obtain the best possible surface finish and with a view to a safe cutting process, it is necessary to apply the correct clamping pressure - the workpiece/piece should be fixed in a clamping fixture, e.g. a clamping bench or workbench

Catalogue	Index	Ø D [mm] Outer diameter	Ø d [mm] Inner diameter	B [mm] Kerf	S [mm] Disc thickness	Z Teeth number	Teeth geometry	Rake angle °	ixdo/dp Driver holes [mm]	U.m.
●	PS602-0210-0001	0210	30	2,7	2,0	54	GS	-5	COMBO	szt.
●	PS602-0216-0001	0216	30	2,7	2,0	72	GS	-5	COMBO	szt.
●	PS602-0216-0002	0216	30	2,8	2,0	54	GS	-5	COMBO	szt.
●	PS602-0254-0001	0254	30	2,7	2,0	80	GS	-5	COMBO	szt.
●	PS602-0254-0002	0254	30	2,8	2,0	68	GS	-5	COMBO	szt.
●	PS602-0260-0001	0260	30	2,7	2,0	80	GS	-5	COMBO	szt.
●	PS602-0260-0002	0260	30	3,2	2,0	68	GS	-5	COMBO	szt.
●	PS602-0305-0001	0305	30	2,8	2,0	96	GS	-5	COMBO	szt.
●	PS602-0305-0002	0305	30	3,2	2,0	72	GS	-5	COMBO	szt.

INFO:

Miter saws available on the market can be modified by their producers. That is why we request you to check the miter saw you have before purchase of particular saw blade (especially important to check outer diameter and bore).

Download

[TechInfo_PS_eng.pdf](#)

Related products

[HM saw blades MITER 1 -CHIPBOARD-](#)

[HM saw blades MITER 3 -SPECIAL WOOD](#)

[GO Cleaner - cleaning fluid for tools and](#)

[series for miter saws](#)



[/CHIPBOARD- series for miter saws](#)



[machines](#)

