

PS682

HM saw blades STEEL-TECH Electro series for power tools

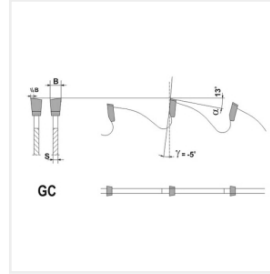
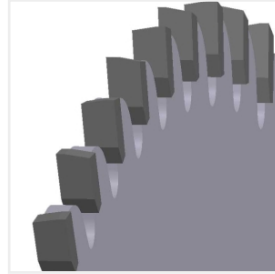

Features - benefits

- » special type of sintered carbides with increased cobalt content and appropriate hardness guarantees increased impact resistance what protects teeth from breaking during cutting of steel elements
- » laser cut disc from high quality, thermally improved steel ensures very precise execution and high tool rigidity
- » special type of sintered carbides and teeth geometry enable to achieve proper cutting efficiency
- » in comparison to cutting with grinding wheels, cutting of steel elements with HM saw blades improves health and safety conditions - decrease of dust and noise level
- » sharpening process performed on CNC sharpening machines with specially chosen grinding wheel and sharpening parameters ensures very sharp sintered carbide edges
- » range of dimensions suitable for most of the power tools available on the market

Application

- » circular saws for so called cold cutting of steel elements guarantee no burns at the cutting edge
- » series designed for cutting elements made from constructional steel like: pipes, profiles, trapezoidal steel sheets with thickness up to 2,5 mm
- » cutting of mild constructional steel with handsaw adjusted for steel cutting (with appropriate rotational speed or rotation regulation)
- » you should be aware of optimal cutting parameters: 160 - 300 rpm (dependent on diameter) while steel cutting
- » recommended rotational speed: 160mm (2 000 - 3 000 rpm), 185mm (1 800 - 2 500 rpm), 200mm (1 700 - 2 400 rpm), 210mm (1 600 - 2 300 rpm)
- » in order to obtain the best possible surface finish and with a view to a safe cutting process, it is necessary to apply the correct clamping pressure - the workpiece/piece should be fixed in a clamping fixture, e.g. a clamping bench or workbench

Catalogue	Index	Ø D [mm] Outer diameter	Ø d [mm] Inner diameter	B [mm] Kerf	S [mm] Disc thickness	Z Teeth number	Teeth geometry	Rake angle °	U.m.
●	PS682-0160-0001	0160	20	2,0	1,4	40	GC	-5	szt.
●	PS682-0185-0001	0185	30	2,0	1,4	48	GC	-5	szt.
●	PS682-0200-0001	0200	30	2,0	1,4	50	GC	-5	szt.
●	PS682-0210-0001	0210	30	2,0	1,4	50	GC	-5	szt.

INFO:

Producers of sawing machines can modify their products during the validity of this offer. Therefore we request you to check the type of sawing machine before order placing (especially outer diameter and bore diameter).

Download

[TechInfo_PS_eng.pdf](#)

Related products

[Saw blades STEEL-TECH for steel profiles cutting](#)

[HM saw blades POWER PLUS 1 -CHIPBOARD- series for power tools](#)

[HM saw blades POWER PLUS 2 -WOOD- series for power tools](#)

[HM saw blades POWER PLUS 3 -UNIVERSAL- series for power tools](#)



[HM saw blades POWER PLUS 4 -BUILD- series for power tools](#)



[GO Cleaner - cleaning fluid for tools and machines](#)

