

PS674

## HM saw blades AKU 1 -WOOD / CHIPBOARD- series for cordless power tools

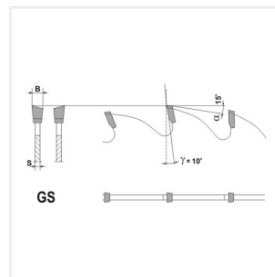
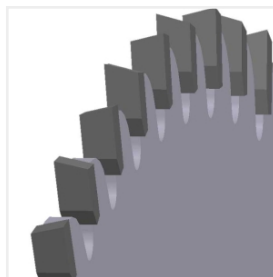

## Features - benefits

- » thin disc made of high quality, heat-treated steel equals surface hardness and high tool stiffness
- » low cutting resistances, thin kerf and lightness of the tool ensure lower cutting resistance, which facilitates tool penetration in the cut material.
- » sintered carbide used guarantees long life time and allows multiple sharpening
- » the sharpening process carried out on numerically controlled CNC sharpening machines with preserving certain operating parameters of the grinding wheel, ensures extremely sharp edges of the tool

## Application

- » ripping and cross cutting of material up to 55mm thick
- » saw blades ideal for mobile applications on the construction site
- » fast, accurate and mobile cross cutting of wood and wood materials
- » specially profiled shape of the tooth and blades (alternate top bevel teeth) allow to obtain very good surface quality of materials cut
- » thin saw blades with reduced power consumption, dedicated to cordless power tools
- » in order to obtain the best possible surface finish and with a view to a safe cutting process, it is necessary to apply the correct clamping pressure - the workpiece/piece should be fixed in a clamping fixture, e.g. a clamping bench or workbench

Catalogue	Index	Ø D [mm] Outer diameter	Ø d [mm] Inner diameter	B [mm] Kerf	S [mm] Disc thickness	Z Teeth number	Teeth geometry	Rake angle °	U.m.
●	PS674-0140-0001	0140	20	1,8	1,2	48	GS	10	szt.
●	PS674-0160-0001	0160	20	1,8	1,2	56	GS	10	szt.
●	PS674-0165-0001	0165	16	1,8	1,2	24	GS	10	szt.
●	PS674-0165-0002	0165	16	1,8	1,2	56	GS	10	szt.
●	PS674-0165-0003	0165	20	1,8	1,2	56	GS	10	szt.

## INFO:

During the validity of Globus tools offer, manufacturers of cordless power tools can modify their products. Therefore, before you purchase a particular dimensions of the saw blade, please check the type of saw (especially important for the outside diameter of the saw blade and the bore).

## Download

[TechInfo\\_PS\\_eng.pdf](#)

## Related products

[HSS saw blades AKU 2 -UNIVERSAL- series for cordless power tools](#)



[GO Cleaner - cleaning fluid for tools and machines](#)

