

PS605

## HM saw blades POWER PLUS 2 -WOOD- series for power tools

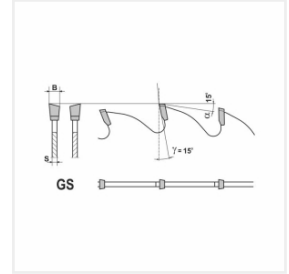
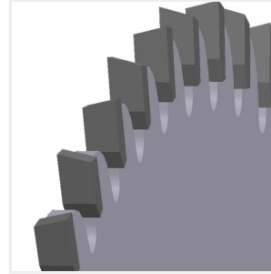

## Features - benefits

- » thin kerf and disc guarantee less cutting resistance which greatly facilitates plunging of the tool into cutting material
- » multi spline hole - a new type of fixing makes putting the saw blade on the clamping sleeve easier, in case of any dirt (dust) enables proper putting and setting of the saw in relation to the shaft and clamping
- » sintered carbide guarantees long life and enables multiple sharpening
- » disc made of thermally improved high-quality steel equals balanced surface hardness and high stiffness of the tool
- » sharpening process implemented on numerically controlled CNC grinders with preservation of specific grinding wheel parameters provides very sharp edges
- » wide range of diameters from 160 to 235 mm, suitable for most power tools on the market

## Application

- » saw blades dedicated for all standard works on processing of wood and other wood-based materials
- » for ripping (i.e. saw blade with 24 teeth) and cross-cutting (i.e. saw blade with 42 teeth) of hard and soft wood, glued wood elements, joinery boards, plywood and other wood-based materials showing fiber direction, etc.
- » specially profiled shape of the tooth shape and blade GS15 (alternate top bevel teeth) allows to keep good surface quality of processed materials
- » can be used also in stationary machines
- » in order to obtain the best possible surface finish and with a view to a safe cutting process, it is necessary to apply the correct clamping pressure - the workpiece/piece should be fixed in a clamping fixture, e.g. a clamping bench or workbench

Catalogue	Index	Ø D [mm] Outer diameter	Ø d [mm] Inner diameter	B [mm] Kerf	S [mm] Disc thickness	Z Teeth number	Teeth geometry	Rake angle °	U.m.
●	PS605-0160-0001	0160	20	2,2	1,4	24	GS	15	szt.
●	PS605-0160-0002	0160	20	2,2	1,4	42	GS	15	szt.
●	PS605-0164-0001	0164	20	2,2	1,4	24	GS	15	szt.
●	PS605-0164-0002	0164	20	2,2	1,4	42	GS	15	szt.
●	PS605-0184-0001	0184	20	2,7	1,6	24	GS	15	szt.
●	PS605-0184-0002	0184	20	2,7	1,6	42	GS	15	szt.
●	PS605-0184-0003	0184	30	2,7	1,6	24	GS	15	szt.
●	PS605-0184-0004	0184	30	2,7	1,6	42	GS	15	szt.
●	PS605-0190-0001	0190	30	2,2	1,4	28	GS	15	szt.
●	PS605-0190-0002	0190	30	2,2	1,4	44	GS	15	szt.
●	PS605-0190-0003	0190	30	2,7	1,6	28	GS	15	szt.
●	PS605-0190-0004	0190	30	2,7	1,6	44	GS	15	szt.
●	PS605-0210-0001	0210	30	2,2	1,4	28	GS	15	szt.
●	PS605-0210-0002	0210	30	2,2	1,4	44	GS	15	szt.
●	PS605-0235-0001	0235	30	2,7	1,6	28	GS	15	szt.
●	PS605-0235-0002	0235	30	2,7	1,6	52	GS	15	szt.

INFO:

Producers of sawing machines can modify their products during the validity of this offer. Therefore we request you to check the type of sawing machine before order placing (especially outer diameter and bore diameter).

## Download

[TechInfo\\_PS\\_eng.pdf](#)

## Related products

[HM saw blades POWER PLUS 1  
-CHIPBOARD- series for power tools](#)



[HM saw blades POWER PLUS 3  
-UNIVERSAL- series for power tools](#)



[HM saw blades POWER PLUS 4 -BUILD-  
series for power tools](#)



[GO Cleaner - cleaning fluid for tools and  
machines](#)

