

PS210

Saw blades for raw wood cross cutting

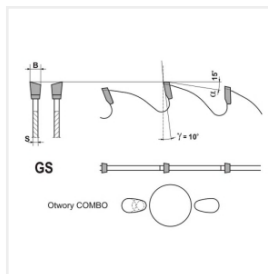
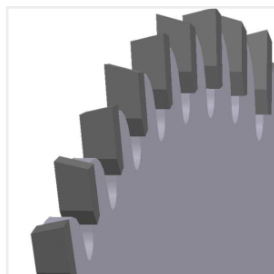

Features - benefits

- » appropriately selected teeth configuration and rake, GS 10 (alternate top bevel), enable obtaining optimal quality of cross cutting
- » additionally saw blades have grooves compensating temperature impact on disc tension fluctuation
- » increased teeth number in a given tool diameter has impact on obtaining smooth surfaces of the cut material particularly in case of dry wood

Application

- » saws designed for soft and hard wood cross cutting (cutting wood across the grain)
- » saws can be used for ripping particularly saws with lower teeth number
- » used on table cut-off machines
- » saws provide good quality of cut surfaces

Catalogue	Index	Ø D [mm] Outer diameter	Ø d [mm] Inner diameter	B [mm] Kerf	S [mm] Disc thickness	Z Teeth number	Teeth geometry	ilxdo/dp Driver holes [mm]	U.m.
●	PS210-0150-0002	0150	30	3,2	2,0	36	GS		szt.
●	PS210-0160-0005	0160	30	2,7	1,6	36	GS		szt.
●	PS210-0180-0002	0180	30	2,7	1,6	30	GS		szt.
●	PS210-0200-0001	0200	30	2,7	1,6	24	GS	COMBO	szt.
●	PS210-0200-0003	0200	30	2,7	1,6	44	GS	COMBO	szt.
●	PS210-0200-0007	0200	30	3,0	1,8	34	GS	COMBO	szt.
●	PS210-0200-0005	0200	30	3,0	1,8	64	GS	COMBO	szt.
●	PS210-0250-0009	0250	30	2,7	1,6	30	GS	COMBO	szt.
●	PS210-0250-0004	0250	30	2,7	1,6	42	GS	COMBO	szt.
●	PS210-0250-0005	0250	30	2,7	1,6	54	GS	COMBO	szt.
●	PS210-0250-0010	0250	30	2,7	1,6	72	GS	COMBO	szt.
●	PS210-0250-0007	0250	30	3,2	2,0	30	GS	COMBO	szt.
●	PS210-0250-0001	0250	30	3,2	2,0	42	GS	COMBO	szt.
●	PS210-0250-0008	0250	30	3,2	2,0	54	GS	COMBO	szt.
●	PS210-0250-0002	0250	30	3,2	2,0	72	GS	COMBO	szt.
●	PS210-0300-0001	0300	30	3,2	2,2	48	GS	COMBO	szt.
●	PS210-0300-0007	0300	30	3,2	2,2	72	GS	COMBO	szt.
●	PS210-0300-0002	0300	30	3,2	2,2	96	GS	COMBO	szt.
●	PS210-0300-0005	0300	30	3,4	2,2	36	GS	COMBO	szt.
●	PS210-0300-0006	0300	30	3,4	2,2	52	GS	COMBO	szt.
●	PS210-0300-0003	0300	30	3,4	2,2	68	GS	COMBO	szt.

Catalogue	Index	Ø D [mm] Outer diameter	Ø d [mm] Inner diameter	B [mm] Kerf	S [mm] Disc thickness	Z Teeth number	Teeth geometry	ilxdo/dp Driver holes [mm]	U.m.
●	PS210-0315-0001	0315	30	2,7	1,6	36	GS	COMBO	szt.
○	PS210-0315-0005	0315	30	2,7	1,6	52	GS	COMBO	szt.
●	PS210-0315-0006	0315	30	3,2	2,0	96	GS	COMBO	szt.
●	PS210-0315-0002	0315	30	3,4	2,2	36	GS	COMBO	szt.
●	PS210-0315-0003	0315	30	3,4	2,2	52	GS	COMBO	szt.
●	PS210-0315-0007	0315	30	3,4	2,2	68	GS	COMBO	szt.
●	PS210-0350-0001	0350	30	3,6	2,5	32	GS	COMBO	szt.
●	PS210-0350-0002	0350	30	3,6	2,5	42	GS	COMBO	szt.
●	PS210-0350-0024	0350	30	3,6	2,5	54	GS	COMBO	szt.
●	PS210-0350-0003	0350	30	3,6	2,5	60	GS	COMBO	szt.
●	PS210-0350-0005	0350	30	3,6	2,5	78	GS	COMBO	szt.
●	PS210-0350-0004	0350	30	3,2	2,0	108	GS	COMBO	szt.
●	PS210-0400-0001	0400	30	4,0	2,8	36	GS	COMBO	szt.
●	PS210-0400-0002	0400	30	4,0	2,8	48	GS	COMBO	szt.
●	PS210-0400-0003	0400	30	4,0	2,8	68	GS	COMBO	szt.
●	PS210-0400-0004	0400	30	4,0	2,8	88	GS	COMBO	szt.
●	PS210-0450-0001	0450	30	4,2	2,8	54	GS	COMBO	szt.
●	PS210-0450-0002	0450	30	4,2	2,8	76	GS	COMBO	szt.
●	PS210-0500-0001	0500	30	4,2	2,8	44	GS	COMBO	szt.
●	PS210-0500-0002	0500	30	4,2	2,8	60	GS	COMBO	szt.
●	PS210-0500-0003	0500	30	5,0	3,6	84	GS	COMBO	szt.
○	PS210-0630-0001	0630	30	4,4	3,2	60	GS	COMBO	szt.

Legend:

do - driver hole dia

dp - hole pitch dia

Piła z indexu PS210-0630-0001 posiada fasole/otwory chłodzące.

Download

[TechInfo_PS_eng.pdf](#)